



RC3 | SINGLE & DOUBLE SWING DOOR

SHEET 001 - Burglary resistance standard RC3
(in accordance with EN 1627 to 1630)

Tests carried out by the CNPP

All Heinen doors are constructed on the basis of the METAL+ concept, lending them superior basic performance standards.

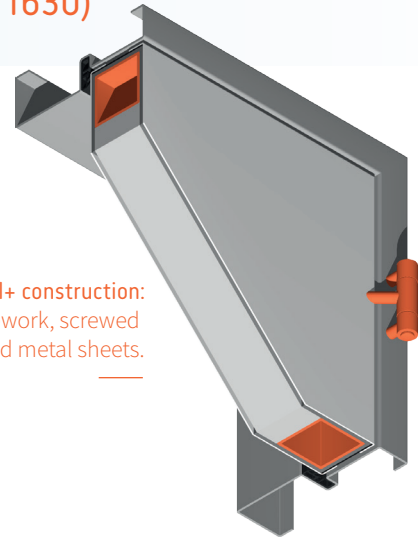

Metal+ construction:
tubular framework, screwed on hinges and metal sheets.

Basic performance features of the RC3 door:



Burglary resistance (EN 1627-1630)
RC3



Acoustic performance
Basic soundproofing: $R_w = 30$ dB



Airtightness
Level L1



Thermal insulation
T4: Av. U 1.9 W/m²K
(with automatic door bottom seal)



Frequency of use
200,000 open/close cycles (max. level)



Mechanical resistance
M4 (max. level)



Service life of the door
15-year warranty on the door set

Possible combinations: ● Fire resistance ● Acoustic performance ● Bullet-proof ● Anti-panic

CROSS-SECTION DOOR RC3 BURGLARY RESISTANCE HINGE SIDE (A12a)

(also available with burglary resistance non-hinge site: A12b).

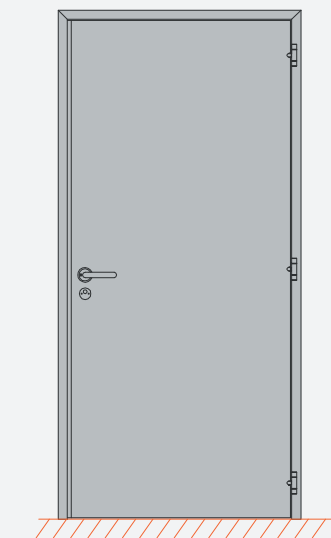

Protected side



Side under attack

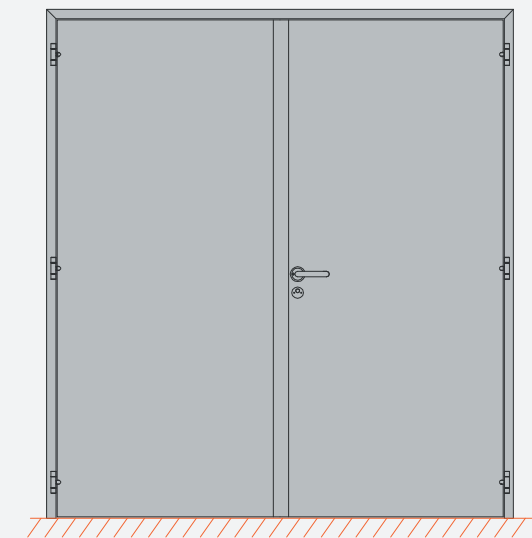

Protected side

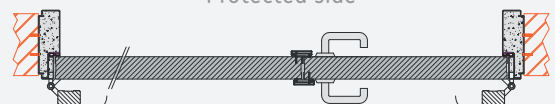

Side under attack

DOOR DIMENSIONS *(always customised)*

Single door

Maximum dimensions	Width	Height
Leaf	1450	3035
Opening	1560	3113

Minimum dimensions	Width	Height
Leaf	700	600
Opening	810	678

Calculation of free passage (excluding combinations):

FP 180° = Width of opening - 140

FP 90° = Width of opening - 210

FP = Height of opening - 90

Larger door sets are also available without a certificate.

Double door

Maximum dimensions	Width	Height
Leaf	1450	3035
Opening	3020	3113

Minimum dimensions	Width	Height
Leaf	400	600
Opening	920	678

Calculation of free passage (excluding combinations):

FP 180° = Width of opening - 140

FP 90° = Width of opening - 280

FP = Height of opening - 90

SECURITY LOCKS

Mechanical systems

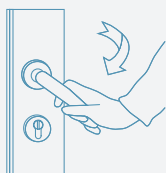

Security (1 and 3 points)

Anti-panic  (1 and 3 points)

Self-Security (1 and 3 points)

Dorma PHA 2500 

Abloy EL 160 

Manual locking

Automatic locking

Systems with automatic locking

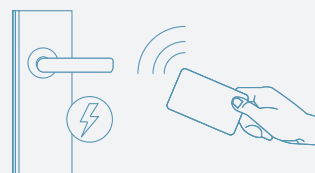

Overlock  (in combination with Self-Security 1 or 3 points).

Controlled entry: Fail secure.

Free anti-panic exit or controlled exit (Fail secure).

EL560, 561 

Controlled entry: Fail safe or Fail secure.

Free anti-panic exit or controlled exit (Fail idem entry side).

EL518, EL520 

Controlled entry: Fail secure.

Free anti-panic exit or controlled exit (Fail secure).

EL532

Controlled entry: Fail secure.

Controlled exit: Fail safe.

BB-LOCK A1B6017HE-ASP 

Controlled entry: Fail secure.

Free exit (handle) or controlled exit (Fail secure).

Solenoid locks

Motorised locks



Fail secure: operation by power supply.

Fail safe: operation by power cut.

WINDOW CONFIGURATIONS

Solid or glazed. Combining anti-panic with glazing upon request.

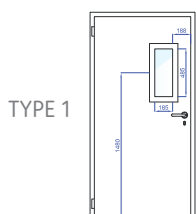

TYPE 1

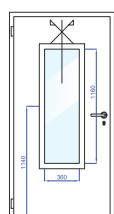

TYPE 2

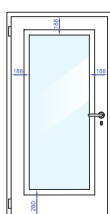

TYPE 3

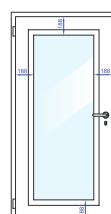

TYPE 4

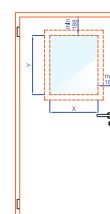

TYPE CUSTOMISED

DETAILS OF MAIN COMBINATIONS



Fire resistance

Tests carried out by the fire resistance testing laboratory at the University of Liège.
E11-30 - E11-60 - E11-120
E12-30 - E12-60 - E12-120 - E12-180
Cannot be combined with the bullet-proof protection performance feature.



Bullet-proof

Tests carried out by the Banc National d'Épreuve, Saint Étienne.
FB4
Cannot be combined with the fire-resistance performance feature.



Acoustic performance

Tests carried out by the testing laboratory at the University of Liège.
Soundproofing (Rw) up to 54 dB.
Standard lock, double Shall-Ex, brushes.
Can be combined with fire resistance and bullet-proof protection performance features.



Anti-panic

Anti-panic bar or handle.
Glazing upon request.

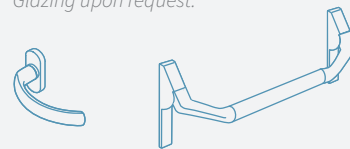

FITTINGS

BASIC FITTINGS

- 1 | **Door frame and leaf finish**
Hot-dip galvanised steel (275 g/m², 20µm thick) or RAL paint.
- 2 | **Hinges**
Minimum two steel hinges, adjustable and replaceable.
- 3 | **Handles**
A set of two U-shaped aluminium handles.
- 4 | **Europrofil cylinder**
EN 1627 compliant (class 4.1 in accordance with EN 1303).
- 5 | **Backplate**
Stainless steel backplate with round hole.
- 6 | **Security stud system**
Burglary resistance hinge side: two security studs.
Burglary resistance non-hinge side: not necessary.
- 7 | **Lock**
Security 1 point.
- 8 | **Latch protection system**
Burglary resistance hinge side: T.
Burglary resistance non-hinge side: not necessary.

OPTIONAL FITTINGS

- 1 | **Door frame and leaf finish**
Stainless steel 304, 316.
- 2 | **Hinges**
One or more hinges can be added; these are always adjustable and replaceable.
Stainless steel.
- 3 | **Handles**
Handles, doorknobs, pull handles etc. in aluminium or stainless steel.
- 9 | **Door closer**
With scissor arm or sliding arm, fitted on the hinge or non-hinge side, invisibly integrated, with or without closure selectors, open position maintained etc.
- 10 | **Ventilation**
RC3 compliant ventilation grilles without combination of performance features.
Maximum width = leaf - 210, customised height.
- 11 | **Security locks**
See locks.
- 12 | **Remote surveillance**
Indication of leaf position, locking latch position, indication of leaf status.
- 13 | **Various options**
Soundproof doorsills, door stops, storm chains, impact plates and many other fittings...

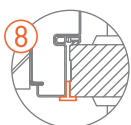
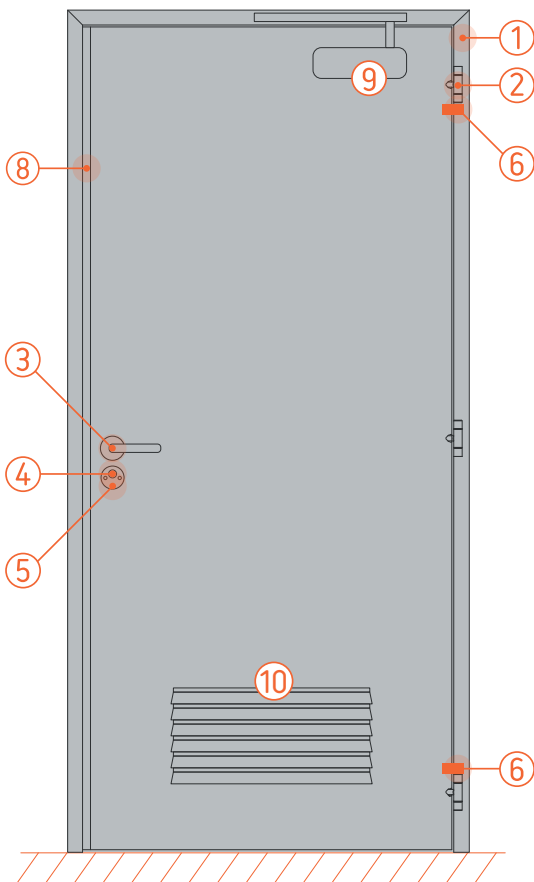

BASIC PERFORMANCES OF THE METAL+ DOOR

- **Frequency of use:**
1,000,000 open/close cycles (maximum level)
- **Mechanical resistance:**
M+7 (maximum level)
- **Service life of the door:**
15-year warranty on the door set!
- **Burglary resistance:**
RC2 (subject to conditions)
- **Acoustic performance:**
Basic soundproofing (Rw) = 30 dB
- **Air tightness:**
Level L1
- **Thermal insulation:**
T4: Av. U ≈ 1.9 W/m²K (with automatic door bottom seal)

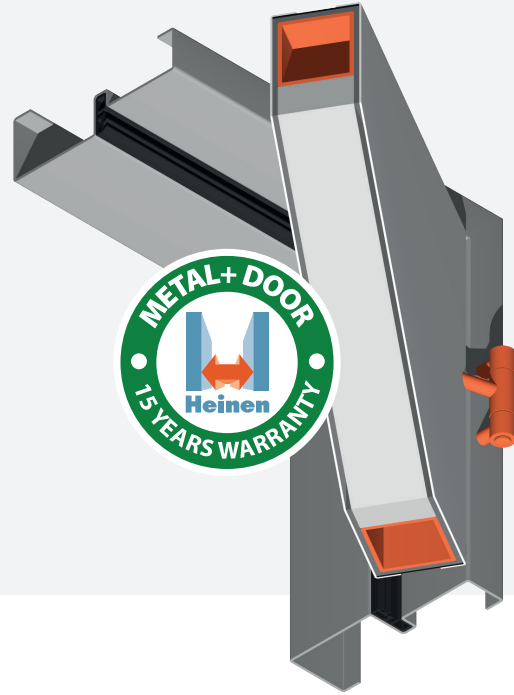

Heinen doors can combine performance features on a bespoke basis. Depending on your needs, one or more performance features are added to the basic, robust Metal+ door.



Fire resistance



Burglary resistance



Acoustic performance



Bullet-proof



Blast-proof



Electromagnetic



Anti-panic



Smoke tightness



Thermal insulation



Airtightness



Watertightness



Wind resistance



For BIM files, please consult us. Our products are certified **CE**

Heinen technical data sheet | RC3 - single and double swing door | Sheet 001 - V01EN October 2018

Copyright © EuroDV 2018 | Responsible editor: Eng. Dario Dalla Valle | Non-contractual document.