

Tests carried out by the CNPP 

All Heinen doors are constructed on the basis of the METAL+ concept, lending them superior basic performance standards.

Basic performance features of the RC3 door



Burglary resistance (EN 1627-1630)
RC3



Frequency of use
Up to 1,000,000 open/close cycles (max. level)
+ durability of automatic closure: C5



Mechanical resistance
- M4 (maximum normative level)
- Up to M+7 (maximum level beyond the standards)



Service life of the door
15-year warranty on the door set

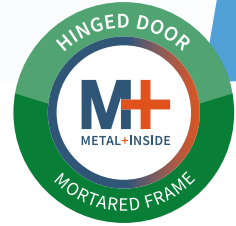
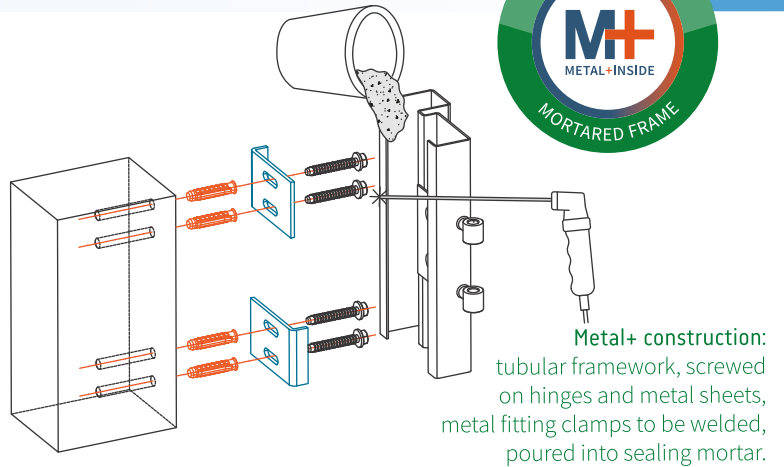

With automatic Kältefeind threshold



Acoustic performance

Basic soundproofing:
- single door RW = 36dB
- double door RW = 30dB



Airtightness

- single door minimum L2
- double door minimum L2 (with door closer)



Thermal insulation

Value between 1.7 and 1.9 W/m²K (depending on dimensions)

Possible combinations: ● Fire resistance ● Acoustic performance ● Bullet-proof ● Anti-panic ● Smoke tightness
● Thermal insulation

CROSS-SECTION RC3 DOOR BURGLARY RESISTANCE HINGE SIDE (DRHE 0021a)

(also available with burglary resistance non-hinge side: DRHE 0021b).

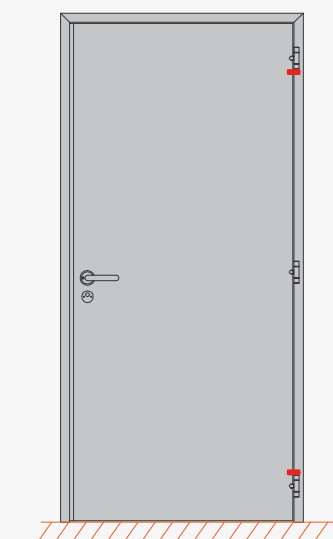

Protected side



Side under attack

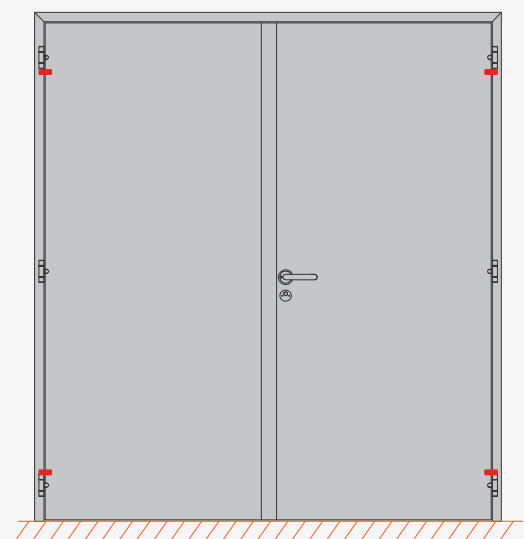

Protected side

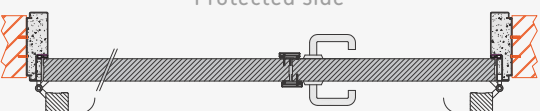

Side under attack

DOOR DIMENSIONS *(always customised)*

Single door

Maximum dimensions	Width	Height
Leaf	2450	5000
Opening	2560	5078

Minimum dimensions	Width	Height
Leaf	700	600
Opening	810	678

Calculation of clear passage (excluding combinations):

FP 180° = Width of opening - 140

FP 90° = Width of opening - 210

FP = Height of opening - 90

Construction support with a minimum thickness of 100 mm.

On request, larger / smaller doorsets are also available without a certificate, this is also valid for the wall thicknesses.

Double door

Maximum dimensions	Width	Height
Leaf	2450	5000
Opening	5020	5078

Minimum dimensions	Width	Height
Leaf	400	900
Opening	920	978

Calculation of clear passage (excluding combinations):

FP 180° = Width of opening - 140

FP 90° = Width of opening - 280

FP = Height of opening - 90

SECURITY LOCKS

NB: one point locking is compliant with the standards untill leaf height of 3035 mm

Mechanical systems

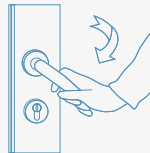

Manual
locking

Security (1 and 3 points)

Anti-panic  (1 and 3 points)

ABLOY EL160  , **EL360** 

Self-Security (1 and 3 points)

Dorma PHA 2500 

Automatic
locking

Electrical systems with automatic locking

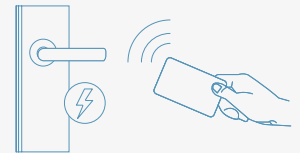

ABLOY EL560  , **EL561**

Controlled entry: Fail safe or Fail secure.

Free anti-panic exit or controlled exit

(Fail idem entry side).

Overlock (in combination with Self-Security 1 or 3 points).

Controlled entry: Fail secure.

Free anti-panic exit or controlled exit

(Fail secure).

Solenoid
locks

ABLOY EL518  , **EL520** 

Controlled entry: Fail secure.

Free anti-panic exit or controlled exit

(Fail secure).

ABLOY EL532

Controlled entry: Fail secure.

Controlled exit: Fail safe.

BB-LOCKS serie A1 HX/HE 

Controlled entry: Fail secure.

Free exit, EN179 (handle) or EN1125 (Push-bar)

With an Adjustable Striker Plate.

BB-LOCKS serie A1 SA/SX/SE

Controlled entry: Fail safe (SA) or Fail secure

(SX and SE). Controlled exit: Fail safe (SA) or Fail

secure (SX and SE). With an Adjustable Striker Plate.

Motorised
locks

 **ABLOY®**

 **DORMA**



Fail secure: operation by power supply.

Fail safe: operation by power cut.

WINDOW CONFIGURATIONS

Solid or glazed. Combining anti-panic with glazing upon request.

TYPE 1

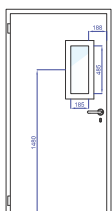

TYPE 2

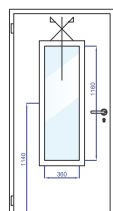

TYPE 3

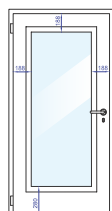

TYPE 4

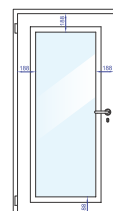

TYPE
CUSTOMISED

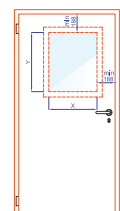

DETAILS OF MAIN COMBINATIONS



Fire resistance

Tests carried out by the fire resistance testing laboratory at the University of Liège.
EI1-30 - EI1-60 - EI1-120
EI2-30 - EI2-60 - EI2-120 - EI2-180



Bullet-proof

Tests carried out by the Banc National d'Épreuve, Saint Étienne.
FB4



Acoustic performance

Tests carried out by the testing laboratory at the University of Liège.
Soundproofing (Rw) up to 54 dB.
Standard lock, double Shall-Ex, brushes.



Anti-panic

Pushbar or handle.
Glazing upon request.



Smoke tightness

Sa, Sm (S200).
Doorbottom seal: contact us.



Thermal insulation

Up to 1.5 W/m²K possible, with thermal break

FITTINGS

BASIC FITTINGS

- 1 | **Door frame and leaf finish**
Magnelis® Hot-dip galvanised ZM 250 steel (250g/m², 20µm thick).
- 2 | **Hinges**
Minimum three screwed steel hinges, adjustable and replaceable
- 3 | **Handles**
A set of two U-shaped aluminium handles.
- 4 | **Europrofil cylinder**
EN 1627 compliant (class 4.1 in accordance with EN 1303).
- 5 | **Backplate**
Stainless steel backplate with round hole.
- 6 | **Security stud system**
Burglary resistance hinge side: two security studs.
Burglary resistance non-hinge side: not necessary.
- 7 | **Lock**
Security 1 point.
- 8 | **Latch protection system**
Burglary resistance hinge side: T.
Burglary resistance non-hinge side: not necessary.

OPTIONAL FITTINGS

- 1 | **Door frame and leaf finish**
Stainless steel 304, 316 or RAL paint.
- 2 | **Hinges**
One or more hinges can be added; these are always adjustable and replaceable.
Stainless steel.
- 3 | **Handles**
Handles, doorknobs, pull handles etc. in aluminium or stainless steel.
- 9 | **Door closer**
With scissor arm or sliding arm, fitted on the hinge or non-hinge side, invisibly integrated, with or without closure selectors, open position maintained etc.
- 10 | **Ventilation**
RC3 compliant ventilation grilles without combination of performance features.
Maximum width = leaf - 210, customised height.
- 11 | **Security locks**
See locks.
- 12 | **Remote surveillance**
Indication of leaf position, locking latch position, indication of leaf status.
- 13 | **Various options**
Soundproof doorsills, door stops, storm chains, impact plates and many other fittings...

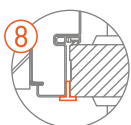
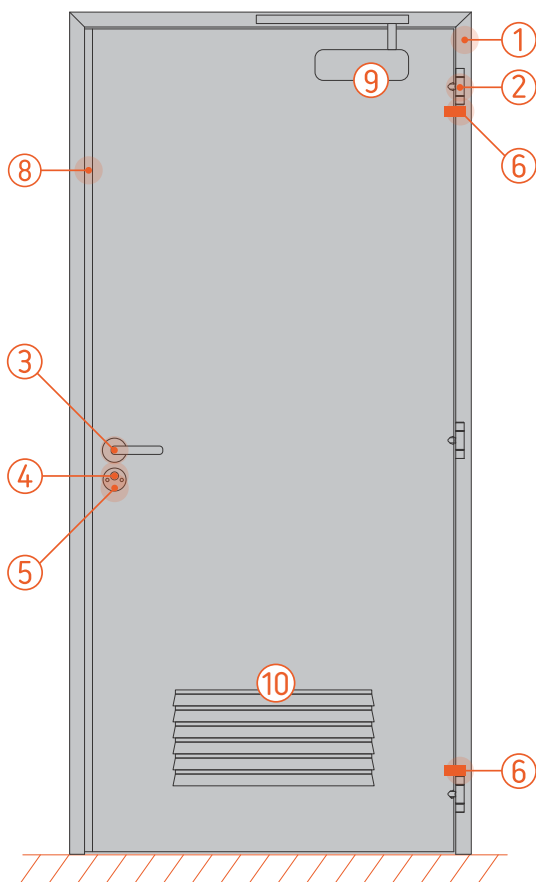

Heinen doors can combine performance features on a bespoke basis. Depending on your needs, one or more performance features are added to the basic, robust Metal+ door. Some performances are only available with the welded and mortar filled installation method.



Fire resistance



Burglary
resistance



Acoustic
performance



Bullet-proof



Blast-proof



Electromagnetic



Anti-panic



Smoke
tightness



Thermal
insulation



Airtightness



Watertightness



Wind
resistance



www.heinen-doors.com

For BIM files, please consult us. Our products are certified **CE**

Heinen product sheet | RC3 | SINGLE & DOUBLE HINGED DOOR | 2024-02-27_FTBE 0021 - V12 EN

Copyright © Heinen 2024 | Non-contractual document.