



FB6 NS* | SINGLE & DOUBLE HINGED DOOR

FTHE 0042 | Bulletproof FB6 NS (in accordance with EN 1522-1523)
Hinge side attack

*NS : non splitting

Bulletproof

Tests carried out by the BNE



All Heinen doors are constructed on the basis of the METAL+ concept, lending them superior basic performance standards.

Basic performance features of the FB6 NS door:



Bulletproof (EN 1522-1523)
FB6 NS



Burglary resistance (EN 1627-1630)
RC4



Acoustic performance
Basic soundproofing:
- single door RW = 30dB



Frequency of use
200,000 open/close cycles



Mechanical resistance
M4 (max. level)



Service life of the door
15-year warranty on the door set

Possible combinations: ● Burglary resistant ● Fire resistance ● Anti-panic

CROSS SECTION FB6 NS DOOR (DRHE 0042)

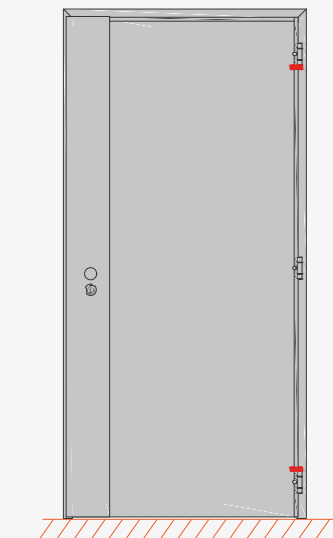

Protected side

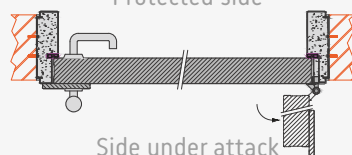

Side under attack

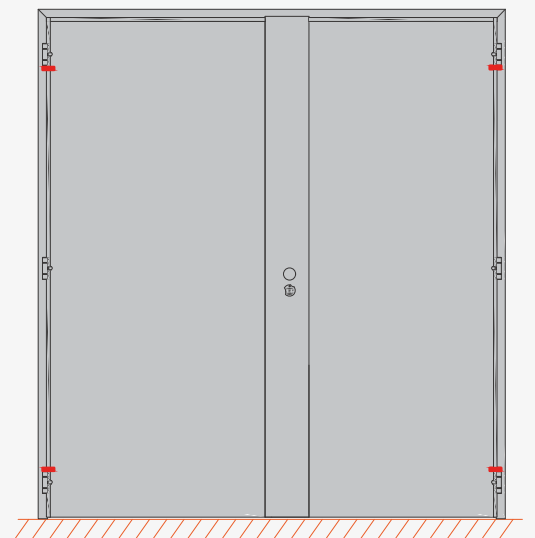

Protected side

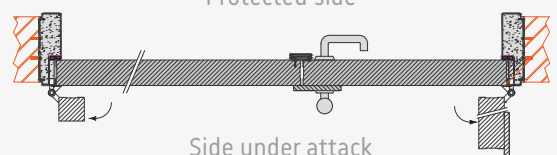

Side under attack



Metal+ construction:
tubular framework, screwed on hinges and metal sheets, metal fitting clamps to be welded, poured into sealing mortar.

DOOR DIMENSIONS *(always customised)*

Single door

Maximum dimensions	Width	Height
Leaf	1450	3035
Opening	1560	3113

Minimum dimensions	Width	Height
Leaf	730	600
Opening	840	678

Calculation of clear passage (excluding combinations):

FP 180° = Width of opening - 140

FP 90° = Width of opening - 220

FP = Height of opening - 90

Double door

Maximum dimensions	Width	Height
Leaf	1450	3035
Opening	3020	3113

Minimum dimensions	Width	Height
Leaf	400	900
Opening	920	978

Calculation of clear passage (excluding combinations):

FP 180° = Width of opening - 140

FP 90° = Width of opening - 300

FP = Height of opening - 90

Construction support with a minimum thickness of 140 mm.

On request, larger / smaller doorsets are also available without a certificate, this is also valid for the wall thicknesses.

SECURITY LOCKS

Mechanical systems

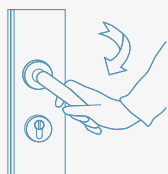

Security (1 and 3 points)

Anti-panic  (3 points)

Self-Security (1 and 3 points)

Manual locking

Automatic locking

Electrical systems with automatic locking

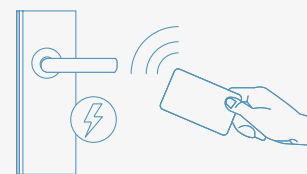

Overlock (in combination with

Self-Security 1 or 3 points).

Controlled entry: Fail secure.

Free anti-panic exit or controlled exit

(Fail secure).

ABLOY EL518 , **EL520** 

Controlled entry: Fail secure.

Free anti-panic exit or controlled exit

(Fail secure).

ABLOY EL532

Controlled entry: Fail secure.

Controlled exit: Fail safe.

Solenoid locks

Motorised locks



Fail secure: operation by power supply.

Fail safe: operation by power cut.

DETAILS OF MAIN COMBINATIONS



Burglary resistance

Tests carried out by the CNPP.
RC5 (EN1627 to 1630).



Anti-panic

Pushbar or handle.
Cannot be combined with glazing.



Fire resistance

Contact us.

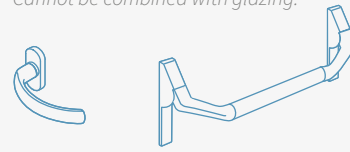

FITTINGS

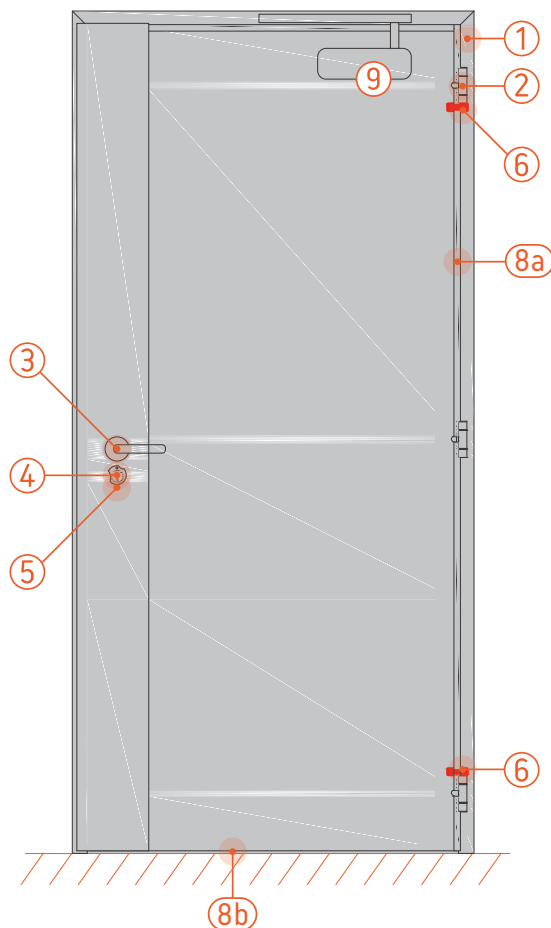

BASIC FITTINGS

- 1 | **Door frame and leaf finish**
Magnelis® Hot-dip galvanised ZM 250 steel (250g/m², 20µm thick).
- 2 | **Hinges**
Minimum three screwed steel hinges, adjustable and replaceable.
- 3 | **Handles**
A set of two U-shaped aluminium handles.
- 4 | **Europrofil cylinder**
EN 1627 compliant (class 6.2 in accordance with EN 1303).
- 5 | **Backplate**
Stainless steel backplate with round hole + bulletproof backplate.
- 6 | **Security stud system**
2 studs.
- 7 | **Lock**
Security 1 point.
- 8 | **Latch protection system**
a. Hinge side: T.
b. Bulletproof Doorbottom seal.

OPTIONAL FITTINGS

- 1 | **Door frame and leaf finish**
Stainless steel 304, 316 or RAL paint.
- 2 | **Hinges**
One or more hinges can be added; these are always adjustable and replaceable.
Stainless steel.
- 3 | **Handles**
Handles, doorknobs, pull handles etc. In aluminium or stainless steel.
- 9 | **Door closer**
With scissor arm or sliding arm, fitted on the hinge or non-hinge side, with or without closure selectors, open position maintained etc.
- 10 | **Security Locks**
See locks.
- 11 | **Remote surveillance**
Indication of leaf position, locking latch position, indication of leaf status.
- 12 | **Various options**
Soundproof doorsills, door stops, storm chains, impact plates and many other fittings...

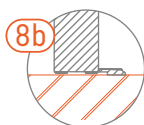
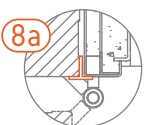

Heinen doors can combine performance features on a bespoke basis. Depending on your needs, one or more performance features are added to the basic, robust Metal+ door. Some performances are only available with the welded and mortar filled installation method.



Fire resistance



Burglary resistance



Acoustic performance



Bullet-proof



Blast-proof



Electromagnetic



Anti-panic



Smoke tightness



Thermal insulation



Airtightness



Watertightness



Wind resistance

